

Procurement of Furniture and IT equipment for BioSense Institute in Novi Sad, Serbia

IOP/72-2024/RD

Clarification no. 2

Issued on September 26, 2024

Regarding the list of questions that the Purchaser, Ministry for Public Investment, No. 11 Nemanjina street, has received from the potential bidders, concerning the procurement procedure: Procurement of Furniture and IT equipment for BioSense Institute in Novi Sad, Serbia IOP/72-2024/RD, we give you the following answers:

Lot no. 2 Office Furniture

Question1 :

Can you confirm the pattern for the compact plate, for all the positions where it is located, whether it is unicolor or wood pattern, considering that the prices are quite different?

Answer 1:

They are unicolor.

Question 2:

Position 2.16 Chest of drawers

Confirm that the back is made of hardboard.

Answer 2:

We confirm.

Question 3:

Position 2.17 Bench

Explain the dimensions of the bench, what is width, depth, height? What material is the shoe rack made of? Is the compact material wood pattern or unicolor? Do you have a picture or sketch?

Answer 3:

The bench consists of two segments both of which are 50 cm high. Segments are connected in an "L" form as shown in the sketch below. Material: double-sided formed melamine board that is unicolor.

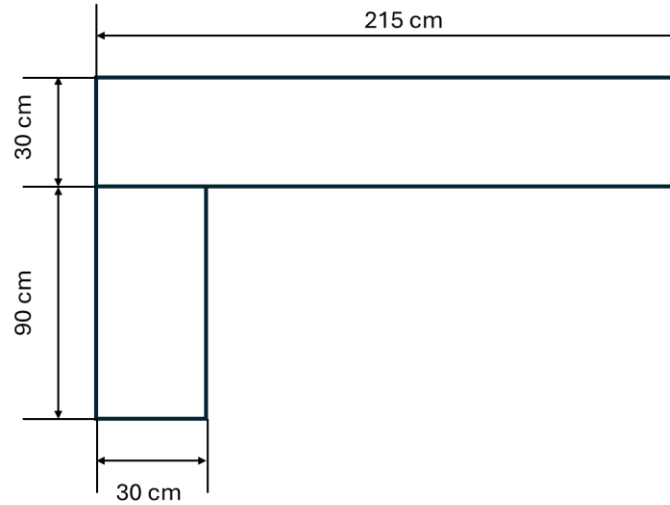

Question 4:

Position 2.21 Stepper

Can you provide a picture or sketch of the stepper to make it clearer what is required since you require them to be stacked. What is the stepper dimension?

Answer 4:

See example pictures below. Any design which includes three steps on at least one side is acceptable. The requirement is meant for the stepper to be foldable (stacked) to save space. The dimensions are dependent on the design itself, but any design has to support standard step height (25 to 28 cm).



Question: 5

Position 2.23 2.24 Closet

Please confirm that the back is made of hardboard, does the cabinet lock, and that it is necessary due to the height to make it from two bodies?

Answer 5:

The back can be made of hardboard, the cabinet does not lock, and it is not necessary to make from two bodies. See attached drawings.

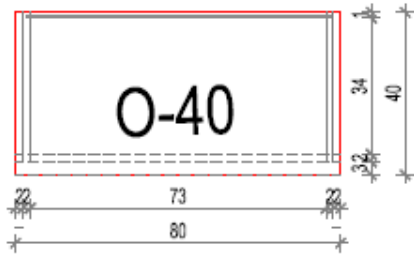

Iverica bela sjaj 18mm.
 1 kant abs beli visoki sjaj 2 mm

podsvetlost polica

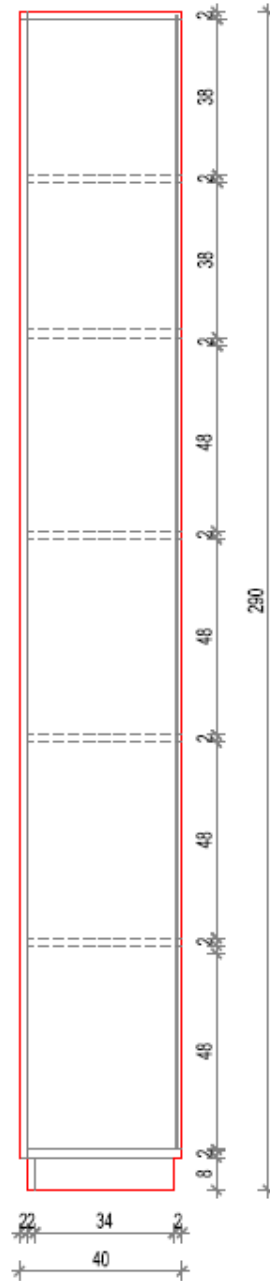
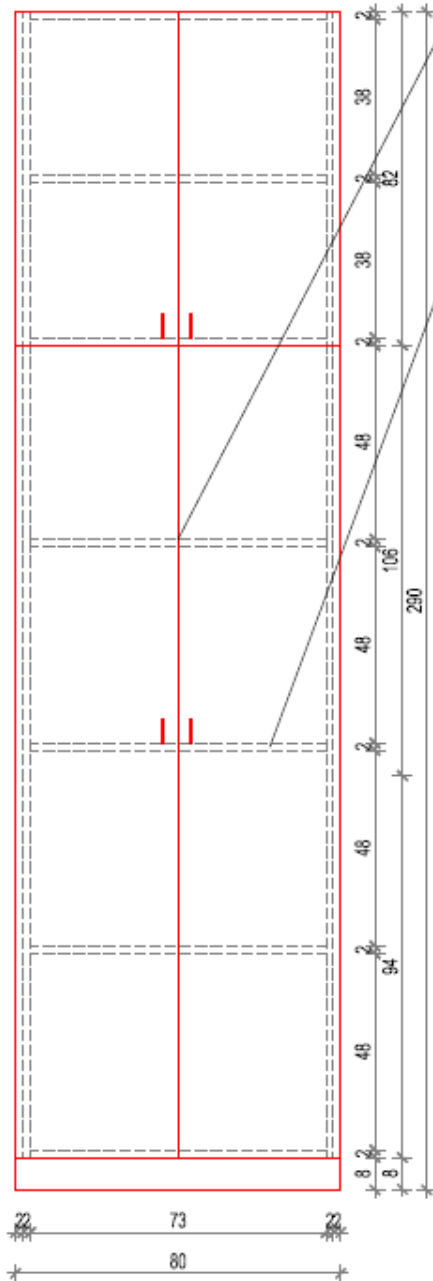

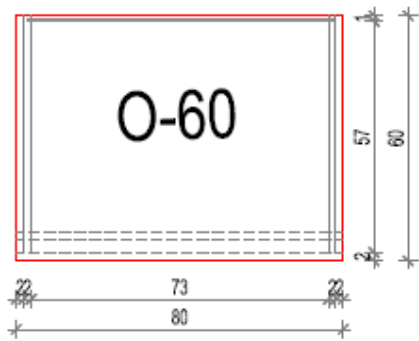

iverica bela sjaj 18mm,
1 kant abs beli visoki sjaj 2 mm

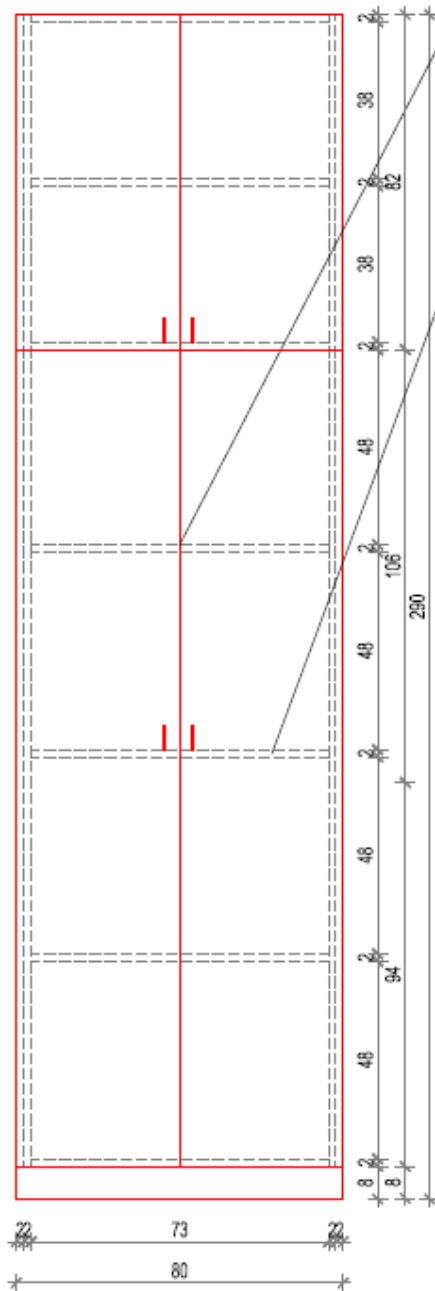

podesivost polica

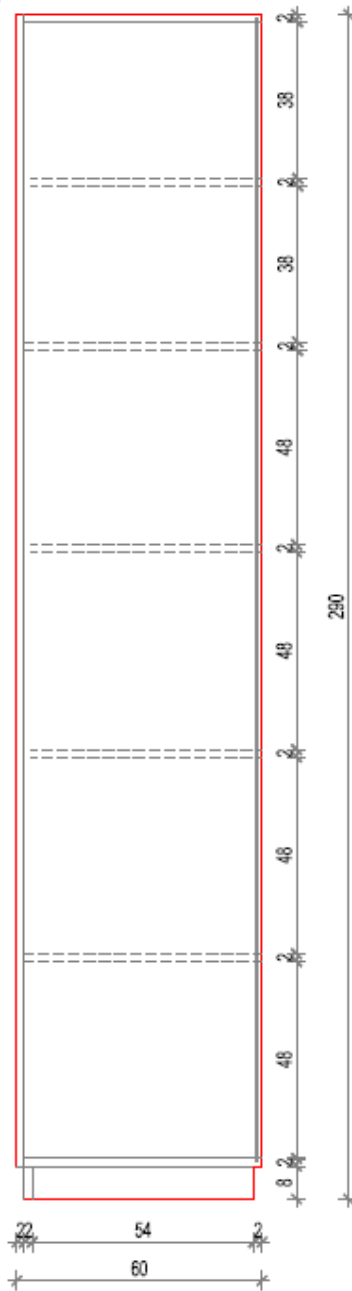

Question 6:

Position 2.26 Open parapet shelves

Considering that these are open shelves, clarify which parts of the shelf are made of high-gloss MFC?

Answer 6:

All sides and fronts as in drawing attached:

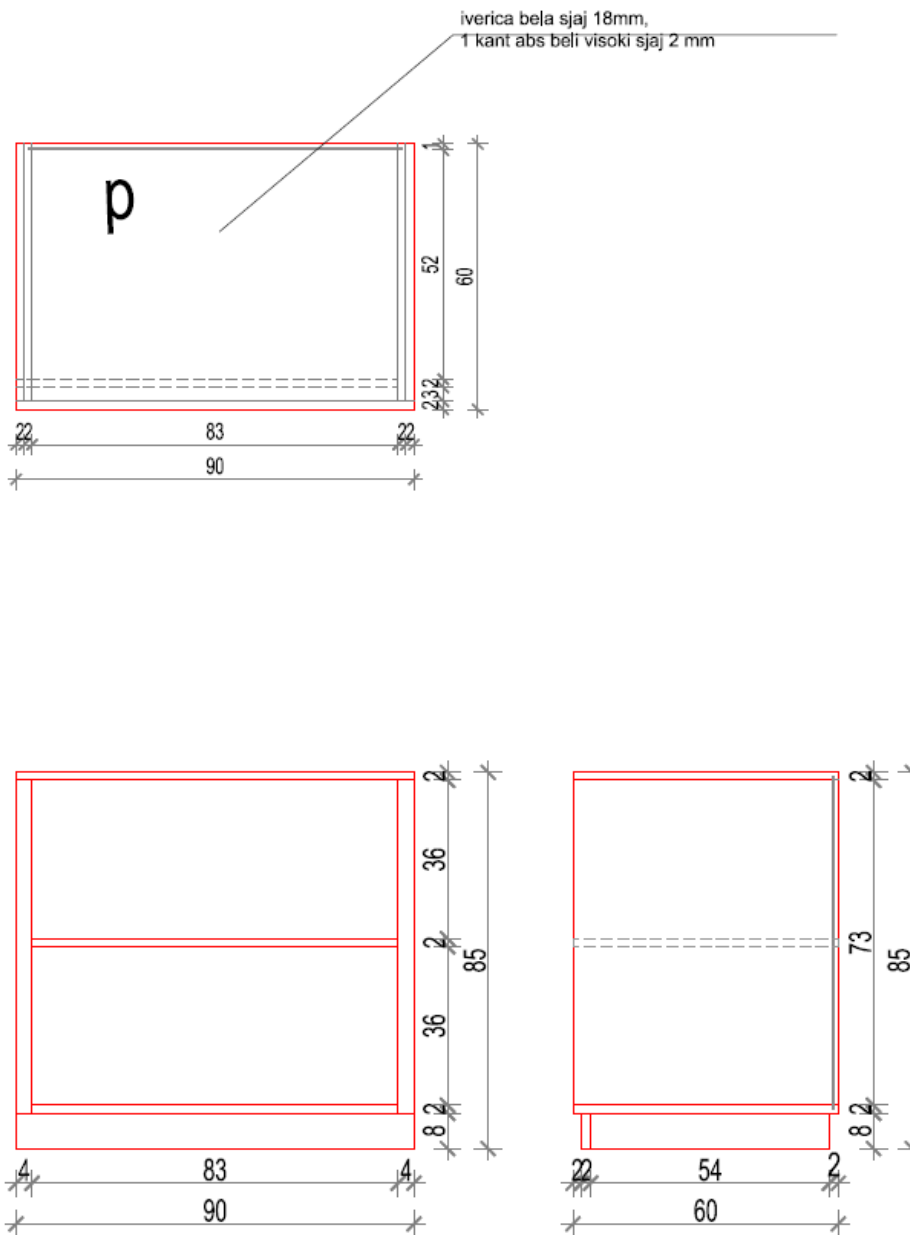

Question 7:

Position 2.27

Clarify whether sockets with protection and a switch are included in the price or are a construction item. Do you have a picture of what these shelves look like? Explain precisely what the shelves, sides and back are made of, which parts are made of metal and which parts are mfc?

Answer 7:

This position is related to the Position 1.96. Sockets and phase switches should be included in the price. The construction part should be made of plasticized metal, while plates should be made of mfc with 2 mm thick ABS edging tape, glued with waterproof PU glue. For additional information see the sketch below.

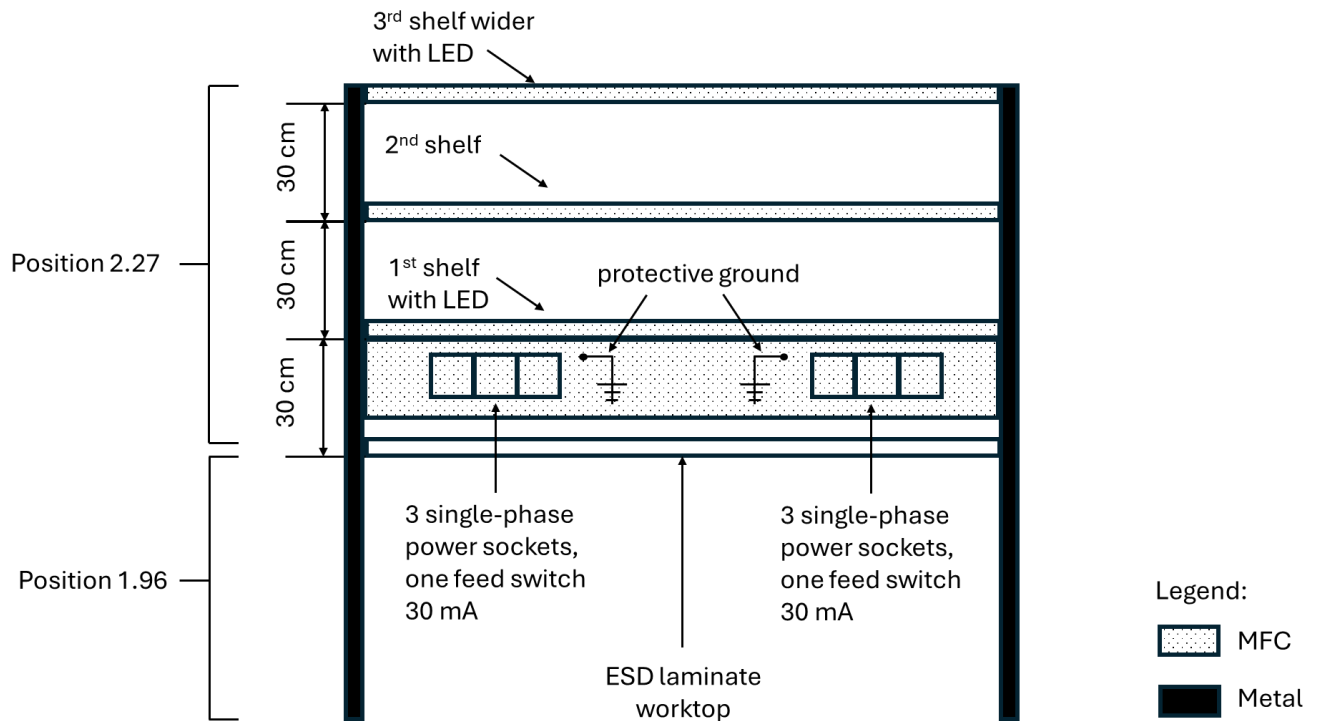

Question 8:

Position 2.28 | 2.29 partition between two rows of tables

Confirm that the sockets are not part of the position?!

Answer

8:

All partitions are to be equipped with modular power sockets and RJ-45 sockets.

Position 2.28 divides a set of eight 2.32 desks (140 cm wide), 2.29 divides a set of six 2.32 desks (also 140 cm wide) and 2.30. divides a set of six 2.34 desks (160 cm wide). See example layout below. Each

desk (both 140 and 160 cm wide) requires a set of four modular standard power sockets and two RJ-45 sockets. The bidders should include the price of sockets into the offered price for the items.

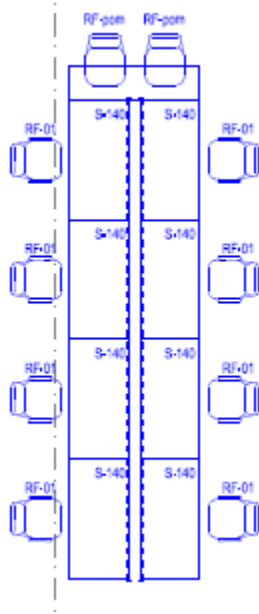

Question 9:

Position 2.31-2.37 Desks and tables

Can we use metal legs with square section 40x40 which are standard for work tables instead of circular section fi 60?

Answer 9:

Yes.

Question 10:

Position 2.39 Work table "Desktop - specific (in the corners)

Do you have a picture or a sketch of the table and what are its dimensions?

Answer 10:

The dimensions are 70 x 70 x 77 cm. The construction is the same as for item 2.32

Question 11:

Position 2.40 Club table

Explain what material the table legs are made of? Are they from the mfc made off, do you have a sketch?

Answer 11:

The legs can be made of metal, MFC or wood.

Question 12:

Position 2.41 and 2.42 Club table

What is the thickness of the top board?

Answer 12:

18mm

Question 13:

Position 2.48 Dining table for kitchen

Explain the construction of the table, i.e. what shape are the legs and what cross-section and how and is the kerok in a color or some pattern considering the wide price range of kerrock?

Answer 13:

See drawing below. Square box legs 10x10 cm and underframe made of plasticized metal or wood, kerrock top should be in the same pattern design as the tops of lower kitchen elements.

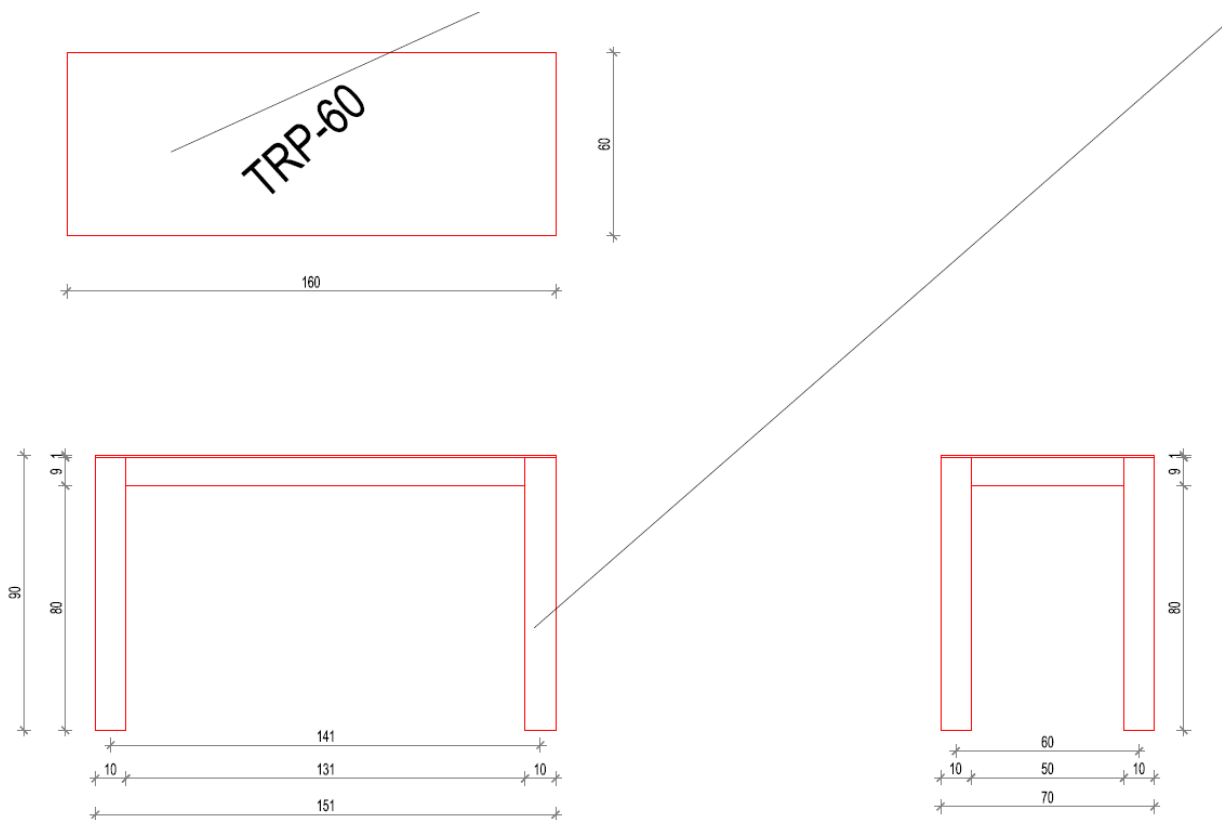

Question 14:

Position 2.49 Kitchen cabinet, 90/60/260

Clarify kitchen set lower cabinet top board?. Is the plinth made of mfc or plasticic.metal?

Answer 14:

Kerrock top of the lower cabinet should be in the same pattern design as the dining table for kitchen, plinth made of MFC.

Question 15:

Position 2.50 Canteen counter

Clarify the appearance and dimensions of the kitchen counter, is it angular, do you have a sketch?

Answer 15:

See drawing below (disregard Serbian text).

- svi nacrani čelični profili kutijasti 4x4 cm palsticifiraju se u Ral 7016 antracit
- na nogaramama završina da ne klizi nekog mekog materijala guma ili silikon

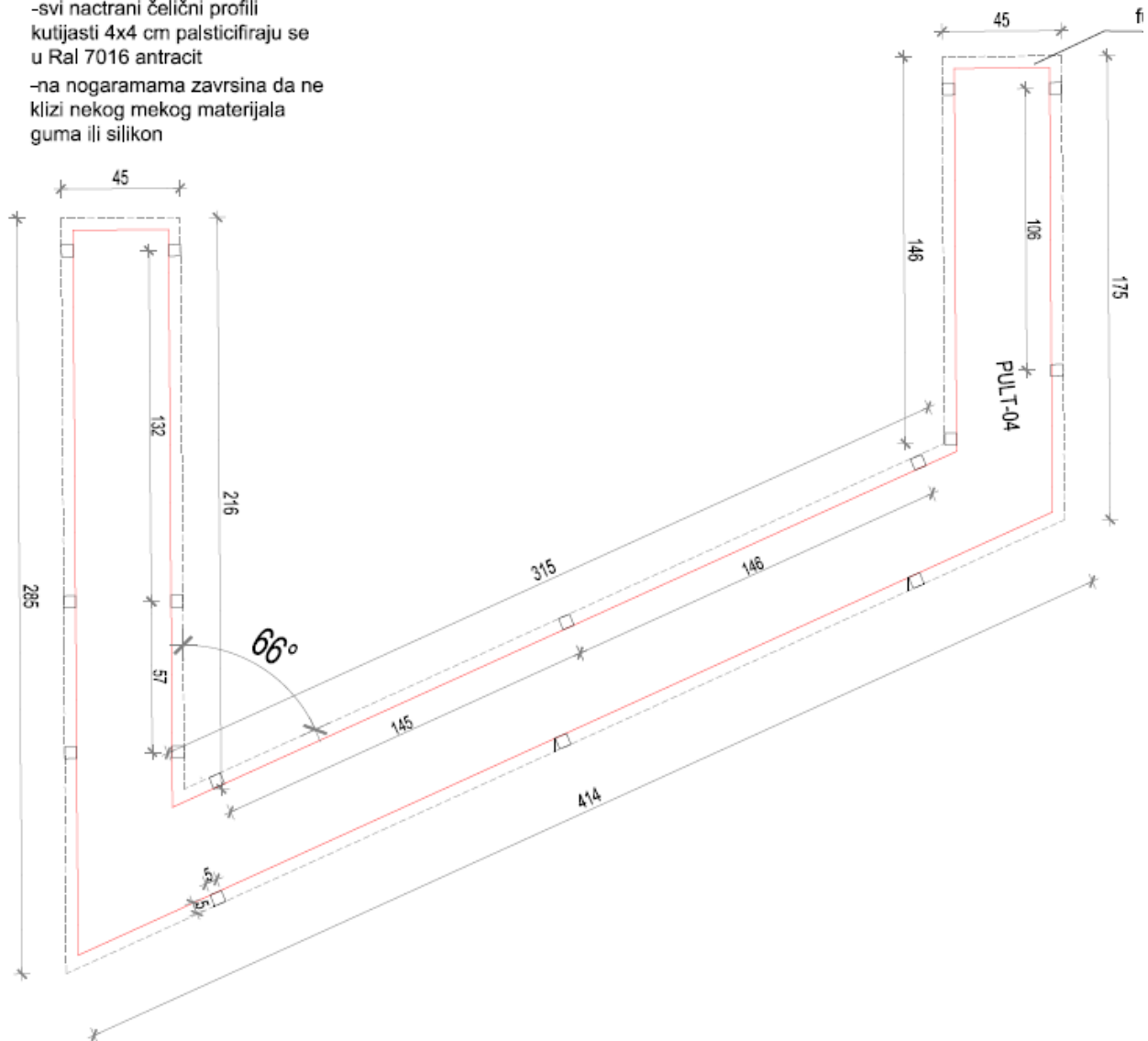

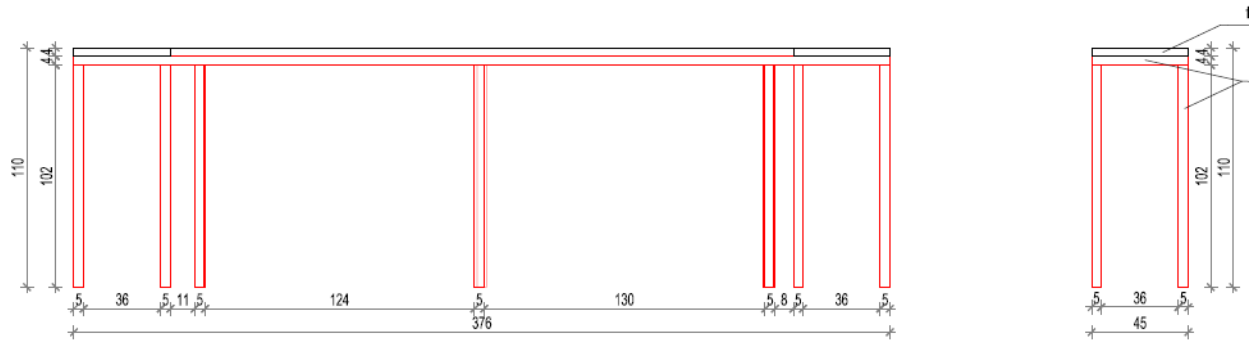

Question 16:

Position 2.51 Bottom element

Clarify the appearance of this element, is it fixed on a metal substructure or does it have wheels, do you have a picture or a sketch or give a more detailed description so that we know what to offer?
is the top board also made of mfc?

Answer 16:

It has does have a fixed metal substructure so it can withhold some weight, i.e. large printer on top, and it does have wheels, so it can be moved. The top board is MFC as described in the specification. We do not have a specific drawing or sketch.

Question 17:

Position 2.55 Canteen booths

Clarify the appearance, shape and dimensions of the booth, do you have a sketch?

Answer 17:

See drawings below.

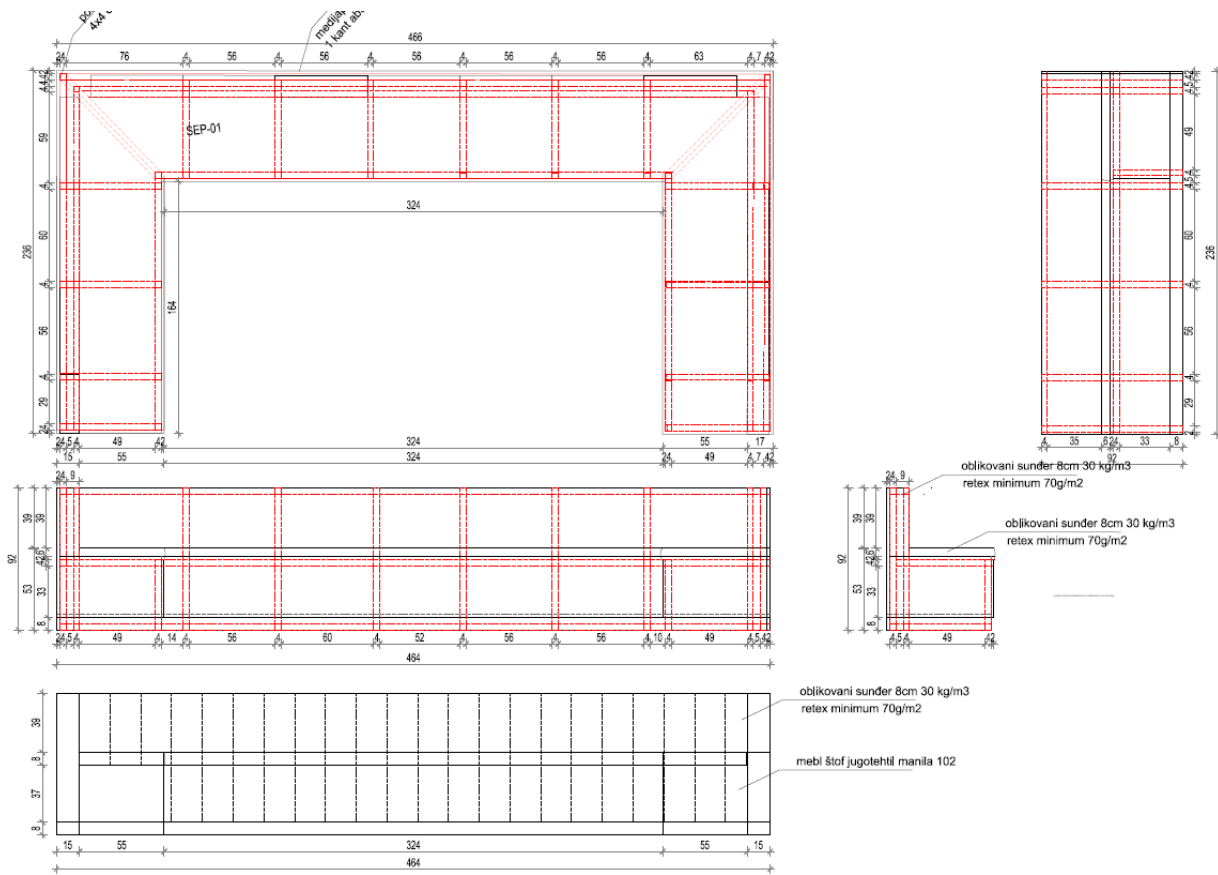

Question 18:

Purchaser has asked as a proof of Bidders technical capability -Manufacturers authorization and after sale Authorization . For some positions in technical specification: it is not possible to get this kind of documents from their authorized dealers because of the nature of the goods, for example:2.5-Trash can, 2.6. Trash can, 2.19-Blue doormat, 2.20-Blue doormat.

Answer 18:

It is acceptable to provide these goods without MAF.

Public Procurement Committee

 Jelena Simić